

RECEIVED
 4 May 2023
 Department of Local Government,
 Sport & Cultural Industries

see tavern and
 beer garden floor
 plan for detail

see diner & cafeteria floor plan for
 detail

LIQUOR CONTROL ACT 1988

The area outlined in red on this plan is the defined licensed area. It is a condition of the licence that this area shall not be altered without approval.

ApplicationID.....A491206372

Decision Date.....28 May 2024

DIRECTOR OF LIQUOR LICENSING

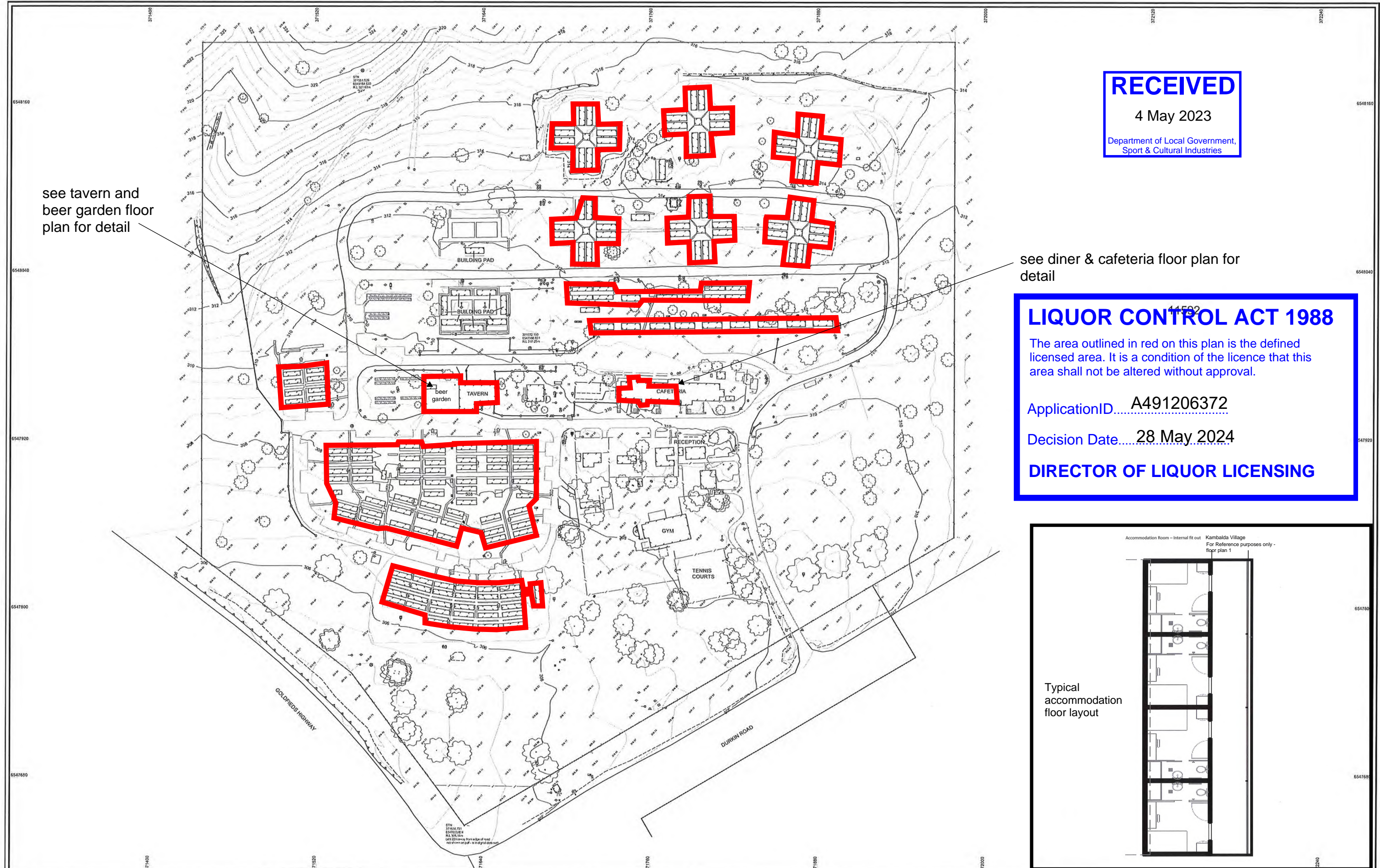
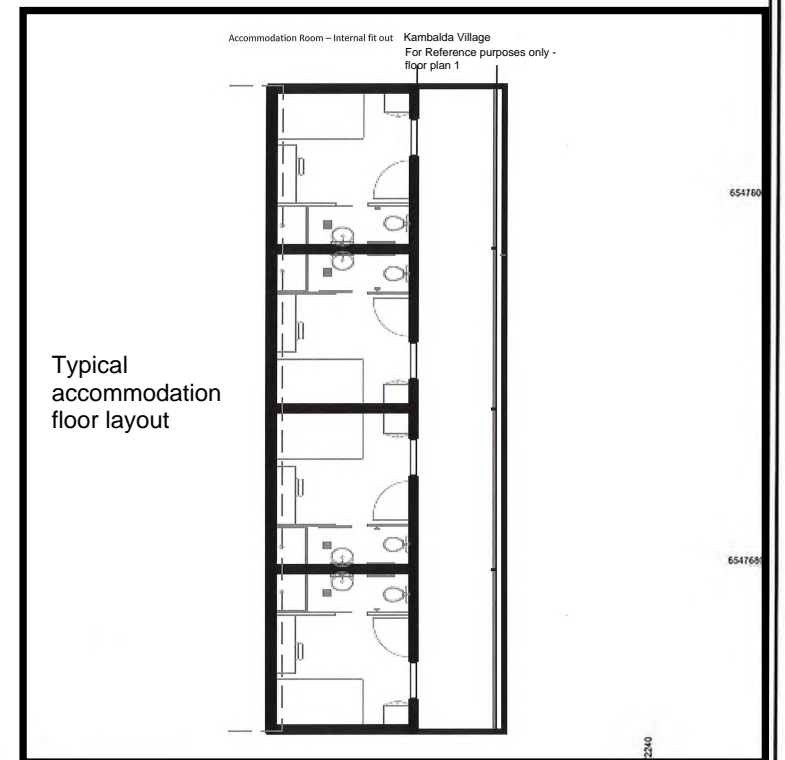

Rev.	Description	Drawn	Date	Checked
A	Initial Issue	SAH	24/02/2022	MAD

SCALE 1:1200 @ A1
 ALL DISTANCES ARE IN METRES

For a true to scale reproduction of this plan, plot it to A1 with the Paging Scaling set to None.

The contents of this plan are current and correct as of the date stated within the revision panel. All consultants and persons making use of this data should satisfy themselves of this data currency by contacting the MNG/Mullen Nolan Group.

Surveyor:- TSO
 Survey Date:- 07/02/2022
 Precal/Cad:- 30/01/2022

150 000 441215 4811-1000000
 GlobalMark.com.au



The boundaries shown on this plan were not re-established as part of this survey, therefore this plan does not guarantee their accuracy. Existing easements, encumbrance or interest are not depicted and a title search is recommended to obtain this information. Re-establishment of the cadastral boundaries is recommended for any proposed works on or near existing boundaries.

MNG

MCMULLEN NOLAN GROUP
 Level 1, 2 Sabre Crescent
 Jandakot, W.A. 6164
 PO Box 3526, Success
 W.A. 6964, Australia
 Offices in: Perth | Melbourne | Kimberley | South West WA

Tel: (08) 6436 1599
 Fax: (08) 6436 1500
 info@mngsurvey.com.au
 www.mngsurvey.com.au
 ABN 90 009 363 311

KAMBALDA ACCOMODATION VILLAGE FEATURE SURVEY

CLIENT: COMPASS GROUP

Project Mgr:- Mark Dobson Datum: MGA50 / AHD

104674 - DE - 001 - A

Job Number Type Plan Number Revision